



Frontier Communications
465 Princeton Dr,
Conway AR 72034

Representative: Destiny Willis

Permit ID: CR 2310

Frontier Communications proposes to place buried fiber optic cable within the ROW of County Rd 2310 within Hopkins County, cable will enter Hopkins County from intersection with FM1870. Starting at GPS 33.126846, -95.544177 within the southern ROW of CR 2310, placing 335' of buried fiber optic cable and ending at GPS 33.127199, -95.545099. Frontier is aware that Hopkins County does not have jurisdiction over TXDOT ROW and that TXDOT approval will have to be obtained.

If you have any questions please contact dwillis@squan.com or amcneeley@squan.com , you can also reach us at 501-548-3321.

Please send the approval back to dwillis@squan.com and amcneeley@squan.com

Thank you

Destiny Willis

<p>X <i>Destiny Willis</i></p> <hr/> <p>Destiny Willis Permitting PM Assistant</p>	<p>X <i>[Signature]</i></p> <hr/> <p>Hopkins County Official</p>
---	---

- Approved
- Denied

Hopkins County Comments:

LEGEND SHEET

PROPOSED BURIED FIBER/ DUCT



PROPOSED AERIAL FIBER ELASHED

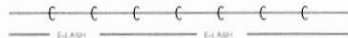

PROPOSED AERIAL FIBER



RIGHT-OF-WAY LINE



PUBLIC UTILITY EASEMENT



EDGE OF PAVEMENT



BACK OF CURB



EDGE OF GRAVEL



ROAD CENTERLINE



SIDE WALKS



WATER



SEWER



STORM DRAIN



GAS



FENCE



RAIL ROAD



EXISTING BURIED COPPER



EXISTING BURIED FIBER



EXISTING AERIAL COPPER



EXISTING AERIAL FIBER



EXISTING FRONTIER UTILITIES



P.U.E.



OTHER EASEMENTS



CULVERT



BOX CULVERT



AERIAL SPAN



COILS



⊙ EX-MAN HOLE

⊠ EX-HANDHOLE

⊗ EX PED

⊙ 11"X11"X16" FLOWER POT

⊠ 17"X30"X24"-HANDHOLE

⊠ 3'X3'X3"-HANDHOLE

⊠ 2'X3'X2"-HANDHOLE

⊠ 30"X48"X36"- HANDHOLE

⊠ 2'X3'X2" - HANDHOLE COMBO

▨ BORE PIT

⊗ PROPOSED PED

○ FRONTIER POLE

× POLE

⊠ REMOVE & REPLACE FRONTIER POLE

× PROPOSED POLE

● WATER HYDRANT

● STORM PIPE FEATURE

● SANITARY MANHOLE

⊙ GAS MARKER



3655 FM 1870
HOPKINS COUNTY

PROJECT NUMBER	C.O. AREA	SULPHUR SPRINGS
DRAWN DATE: 04/26/2024	ENGR: SQJAN PHONE: 361-833-3800	CITY: HUNT
SCALE	TAX DISTRICT: 8888	DWG OF
TWSP: 1188	INO: 888	SEC: 888

MIN D.O.C.
 UNDER NATURAL GROUND
 48"

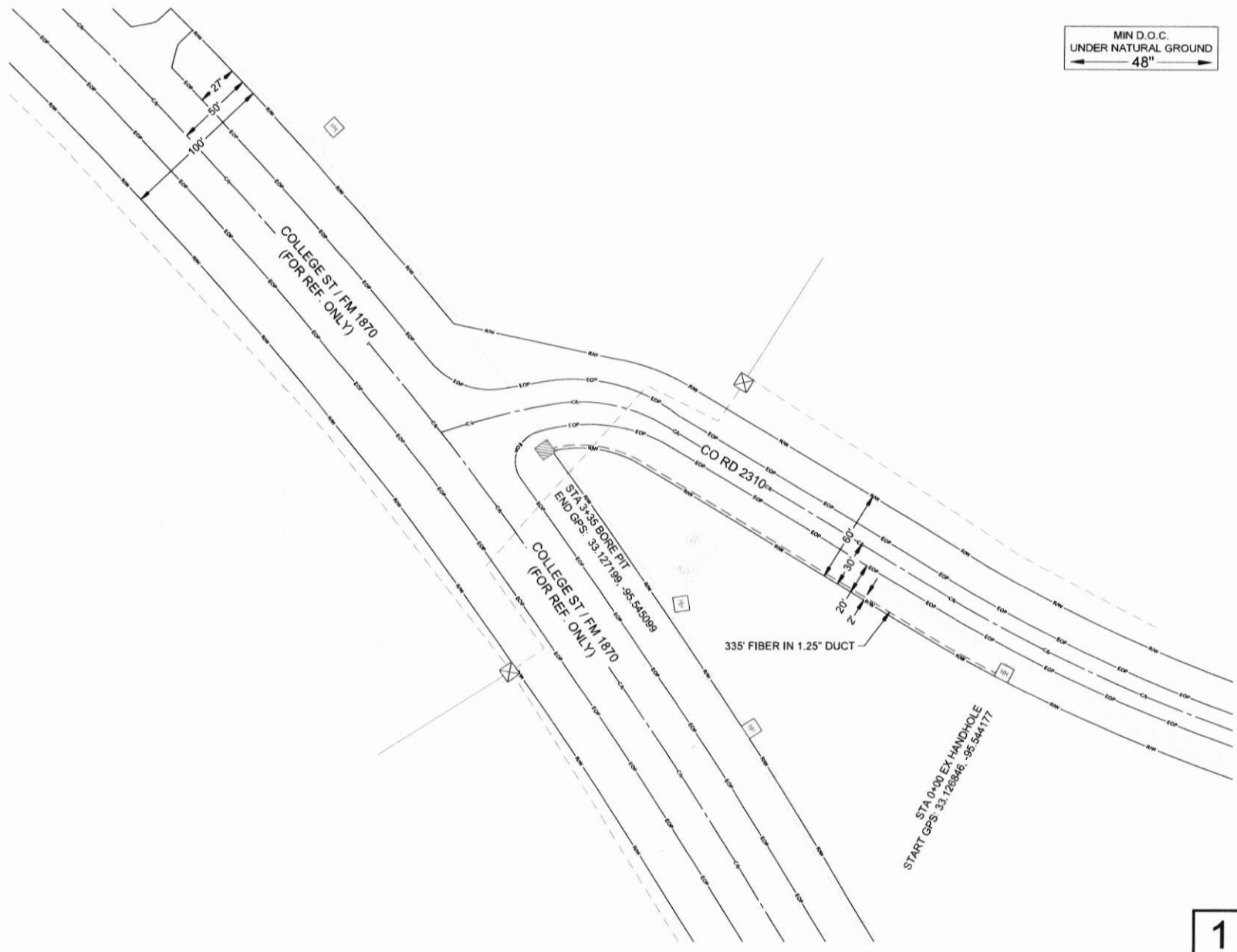

STA 0+00 EX-HAND-HOLE
 START GPS: 33.128840, -95.944177



3655 FM 1870
 HOPKINS COUNTY

PROJECT NUMBER	C.O. AREA	SULPHUR SPRINGS
EXPL. CODE		
CONTRACTOR	ENTY: HUNT	
DATE: 04/26/2024	PHONE: 301-893-0800	FILE
SCALE: 1/80	TAX DISTRICT: 0000	DWG: 1 OF 1
TWNSHIP: 0000	RNG: 0000	SEC: 0000

1



Frontier Communications

465 Princeton Dr,

Conway AR 72034

Representative: Destiny Willis

Permit ID: CR3501- Hopkins County

Frontier Communications proposes to place buried fiber optic cable within the ROW of CR3501 within Hopkins County. Starting at GPS 33.158105, -95.559336 within the eastern ROW, placing 743' of buried fiber and ending at GPS 33.156001, -95.559286.

If you have any questions please contact dwillis@squan.com or amcneeley@squan.com , you can also reach us at 501-548-3321.

Please send the approval back to dwillis@squan.com and amcneeley@squan.com

Thank you

Destiny Willis

X *Destiny Willis*

Destiny Willis
Permitting PM Assistant

X *Wade Barthel*

Hopkins County Official

Approved

Denied

Hopkins County Comments:

LEGEND SHEET

PROPOSED BURIED FIBER/ DUCT



PROPOSED AERIAL FIBER ELASHED

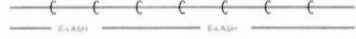

PROPOSED AERIAL FIBER



RIGHT-OF-WAY LINE



PUBLIC UTILITY EASEMENT



EDGE OF PAVEMENT



BACK OF CURB



EDGE OF GRAVEL



ROAD CENTERLINE



SIDE WALKS



WATER



SEWER



STORM DRAIN



GAS



FENCE



RAIL ROAD

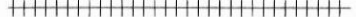

EXISTING BURIED COPPER



EXISTING BURIED FIBER



EXISTING AERIAL COPPER



EXISTING AERIAL FIBER



EXISTING FRONTIER UTILITIES



PROPOSED RIGHT-OF-WAY LINE



REMOVAL CABLE



P.U.E.



OTHER EASEMENTS



CULVERT

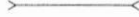

BOX CULVERT



AERIAL SPAN



COILS



Ⓜ EX-MAN HOLE

Ⓜ EX-HANDHOLE

⊗ EX PED

⊙ 11"X11"X16" FLOWER POT

⊠ 17"X30"X24"-HANDHOLE

⊠ 3'X3'X3'-HANDHOLE

⊠ 2'X3'X2'-HANDHOLE

⊠ 30"X48"X36"- HANDHOLE

■ BORE PIT

Ⓜ PROPOSED HANDHOLE

⊗ PROPOSED PED

Ⓜ REMOVE MAN HOLE

Ⓜ REMOVE HANDHOLE

⊗ REMOVE PED

○ FRONTIER POLE

× POLE

Ⓜ REMOVE & REPLACE FRONTIER POLE

× PROPOSED POLE

● WATER HYDRANT

● STORM PIPE FEATURE

● SANITARY MANHOLE

Ⓞ GAS MARKER

FRONTIER

464 CR 3501
HOPKINS

PROJECT NUMBER	464 CR 3501	CO. AREA	SULPHUR SPRINGS
		ENCH. CODE	XXX
DRAWN DATE	ENGR. SQUARE	CITY	HOPKINS
4/15/2024	PHONE 501-632-0800	FILE	
SCALE: #####	TAX DISTRICT: #	DWG	OF
TOWNSHIP: #	RNG: #	SEC	##

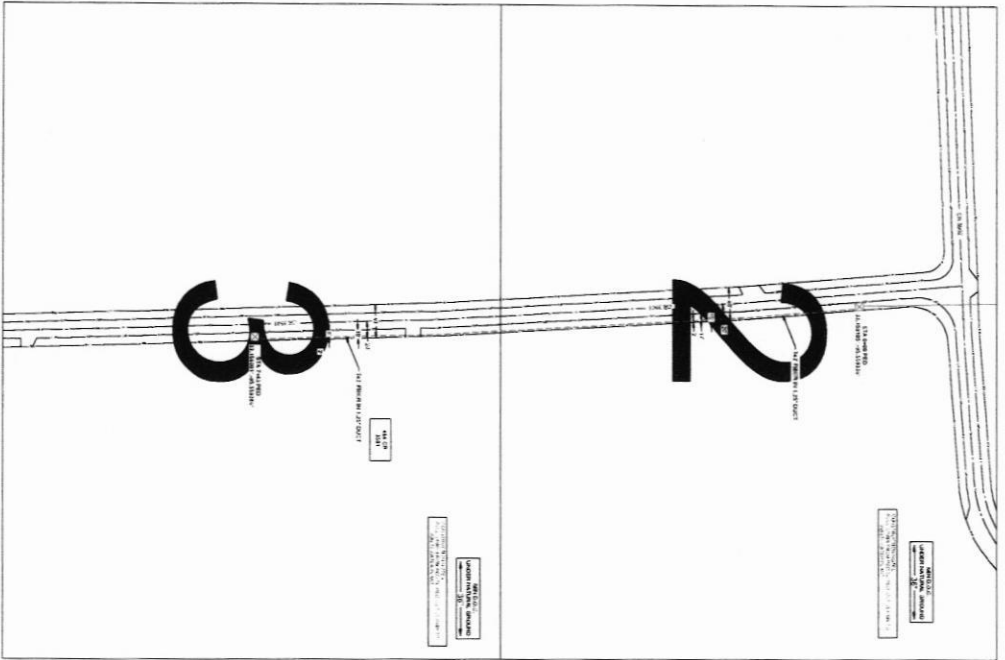

1

PROJECT: 1313 N HILL CREST DR
 HOPKINS
 484 CR 3501



OWNER:	1313 N HILL CREST DR	CONTRACT NO.:	1313N
DATE:	4/15/2024	SCALE:	1" = 40'
DRAWN BY:	JKR/SJM	CHECKED BY:	JKR/SJM
DATE:	4/15/2024	DATE:	4/15/2024
PROJECT NO.:	1313N	PROJECT NO.:	1313N
DATE:	4/15/2024	DATE:	4/15/2024

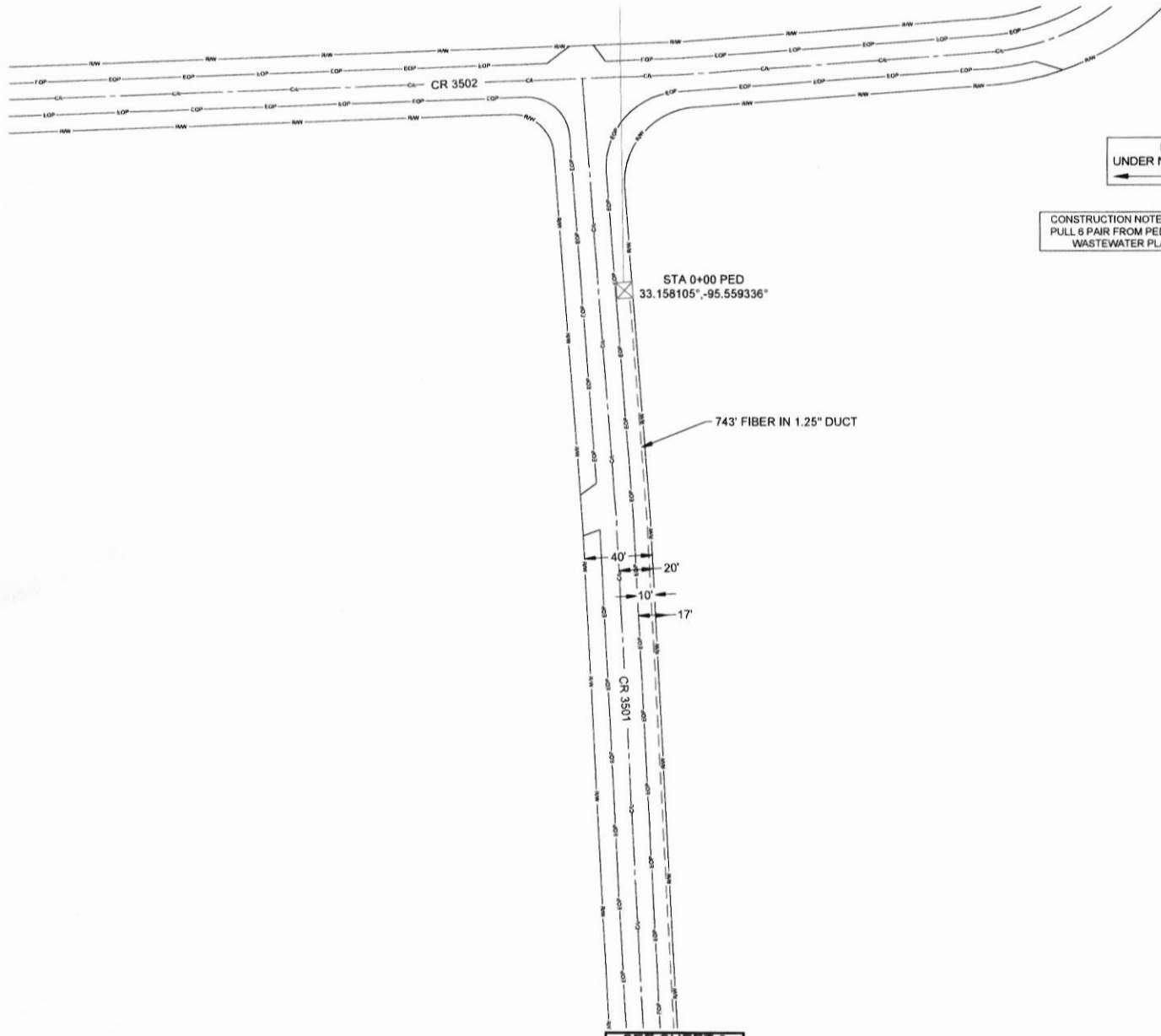

MIN D.O.C.
UNDER NATURAL GROUND
36"

CONSTRUCTION NOTES:
PULL 6 PAIR FROM PED TO PED. CUT 25 PAIR TO
WASTEWATER PLANT

SEE SHEET 3



464 CR 3501
HOPKINS

PROJECT NUMBER	1313 N HILLCREST DR	C.D. AREA	SULPHER SPRINGS
ENGR.	SQUAN	FILE	HOPKINS
PHONE	501-832-0000	DWG	2 OF 3
SCALE	1:60	TAX DISTRICT	Ann
TWP/SP	200P	RNG.	200P
		SEC.	200P

2

SEE SHEET 2

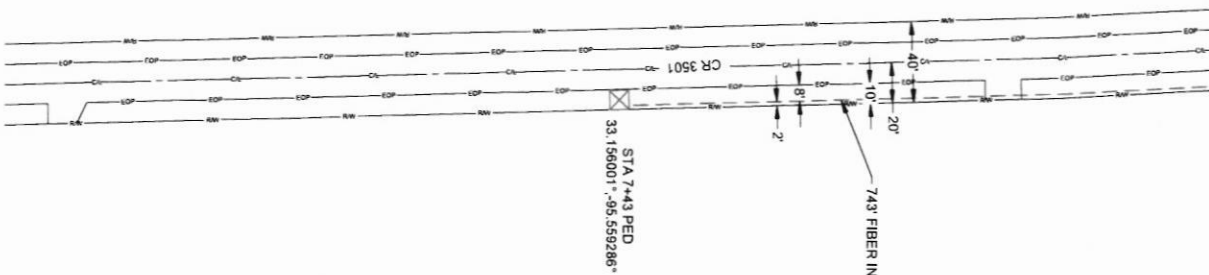

MIN D.O.C.
 UNDER NATURAL GROUND
 36"
 CONSTRUCTION NOTES
 PULL PAIR FROM PED TO PED. CUT 25 PAIR TO
 WASTEWATER PLANT

3

PROJECT		464 CR 3501	
NUMBER		HOPKINS	
1313 N HILLCREST DR		CO. AER. SILVER SPRING	
DATE		FROM DATE TO	
4/15/2024		1/17/2024	
SCALE		SHEET	
1:60		3 OF 3	
DRAWN BY		CHECKED BY	
[Signature]		[Signature]	

